

PHASES 1, 2 & 3.

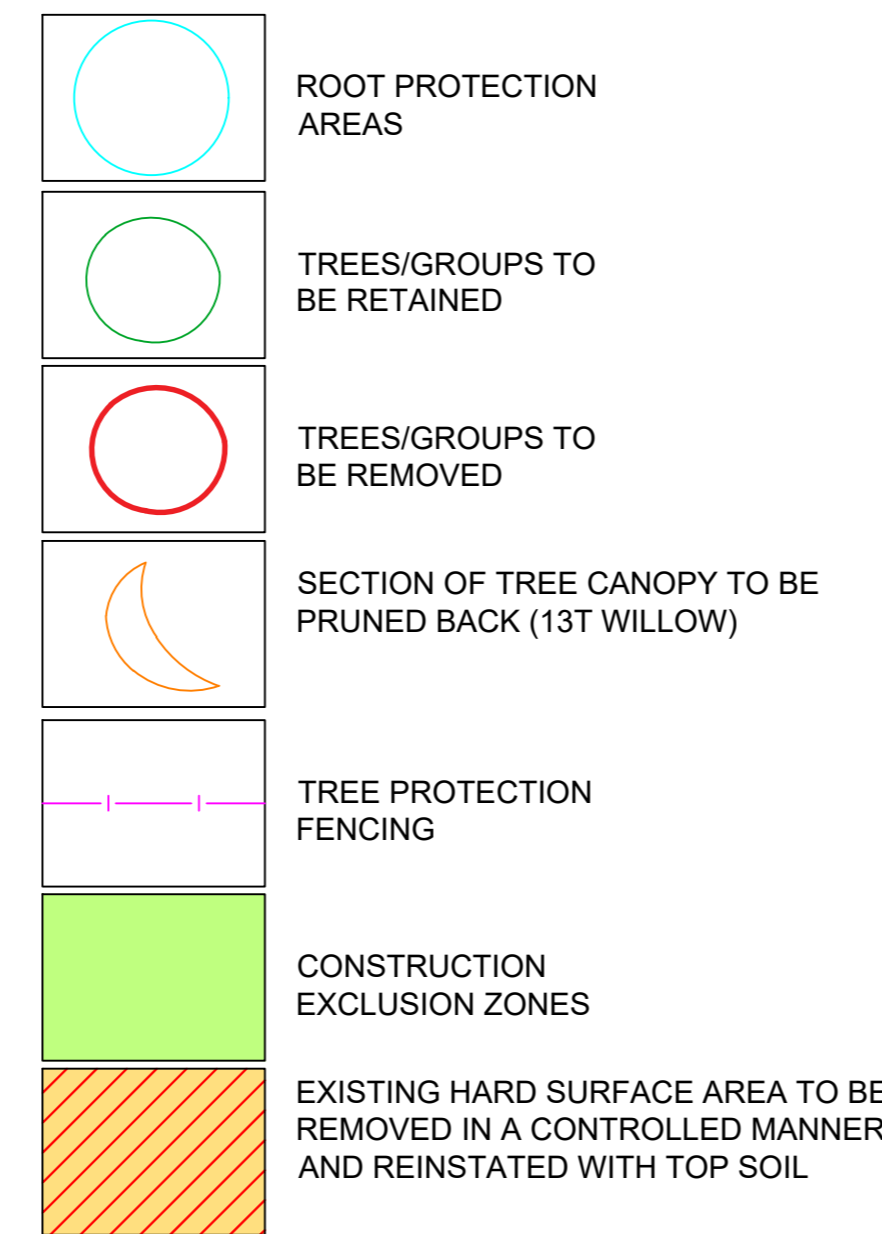

PHASES 4, 5, 6 & 7.

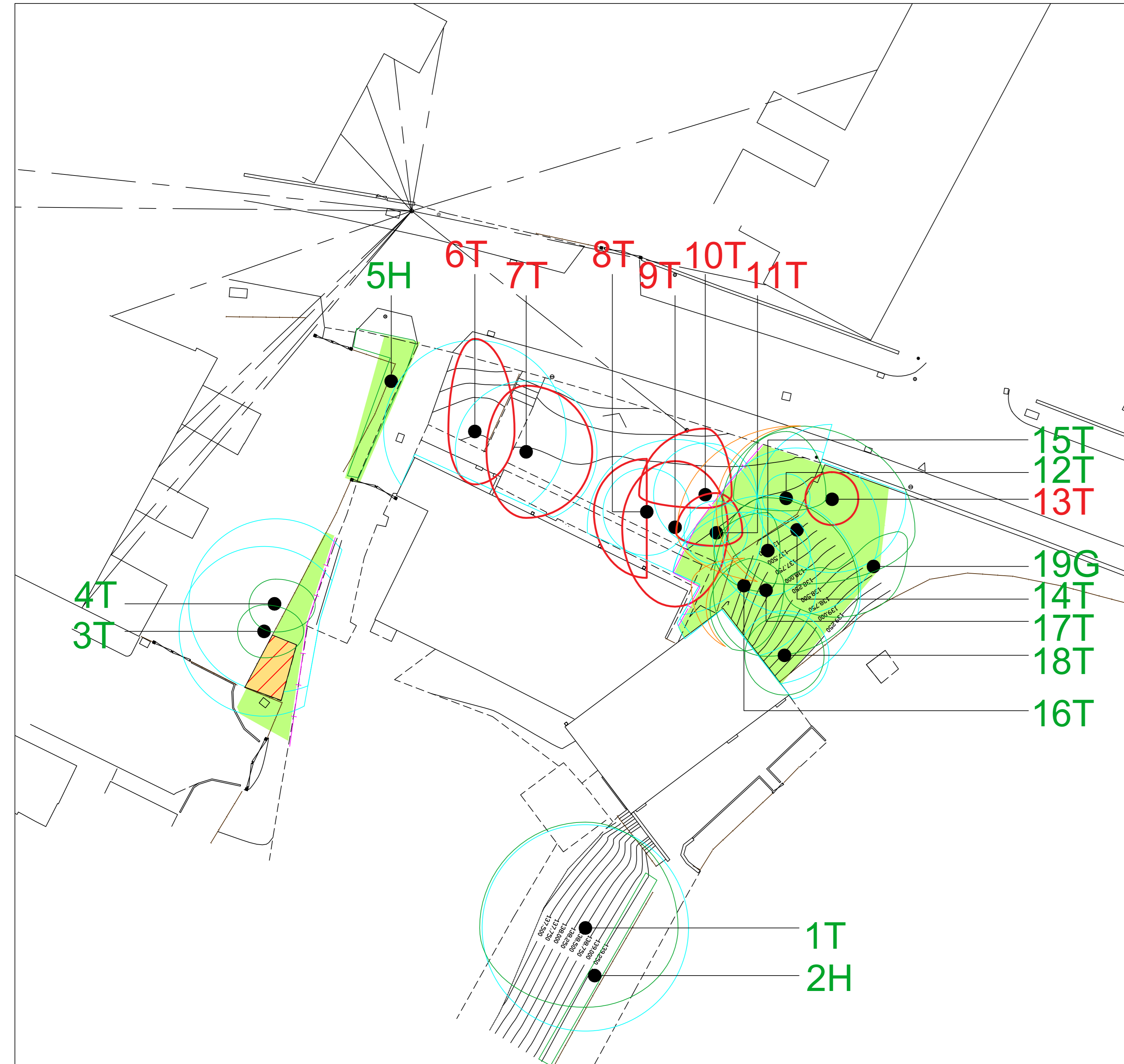
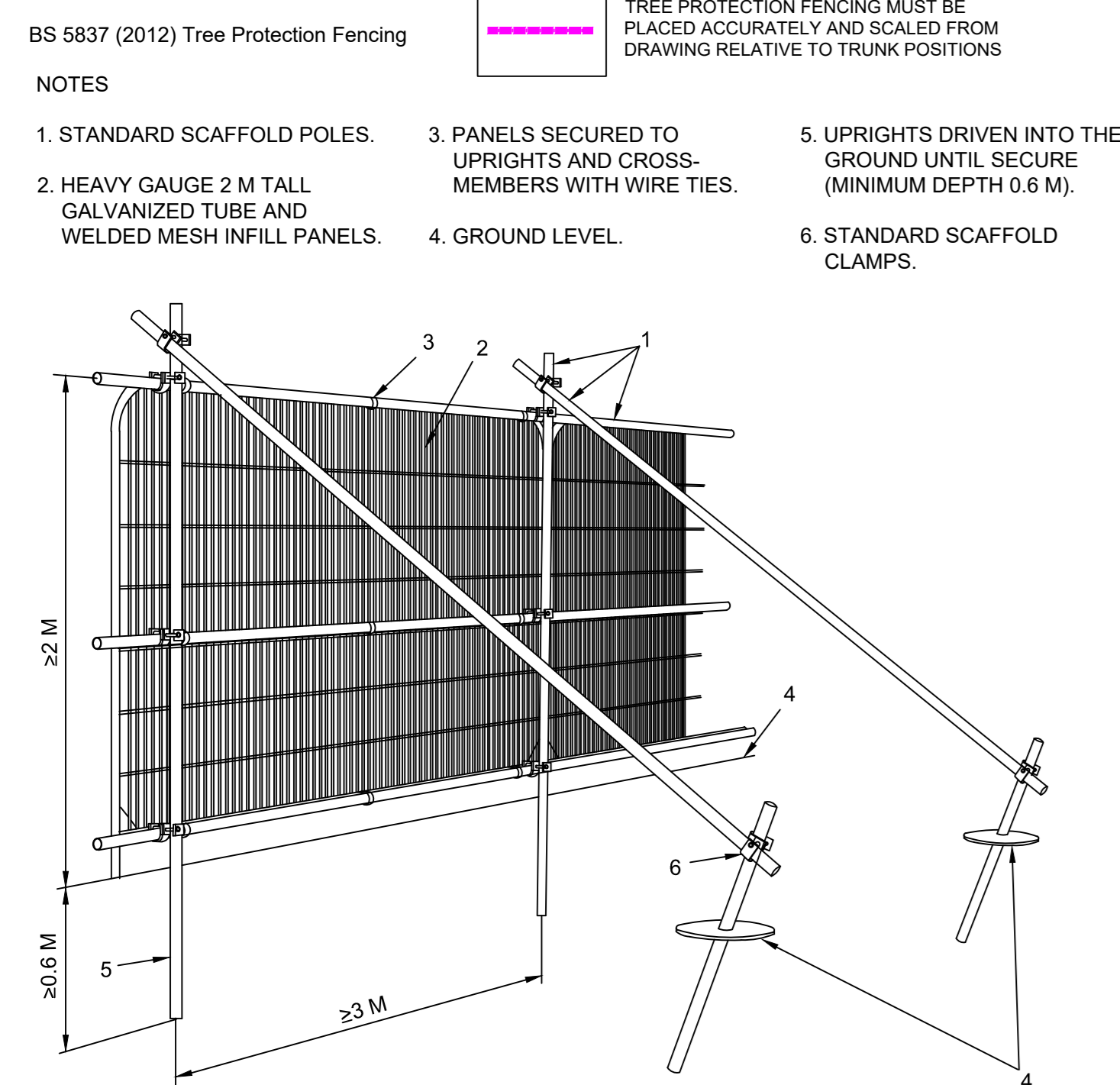
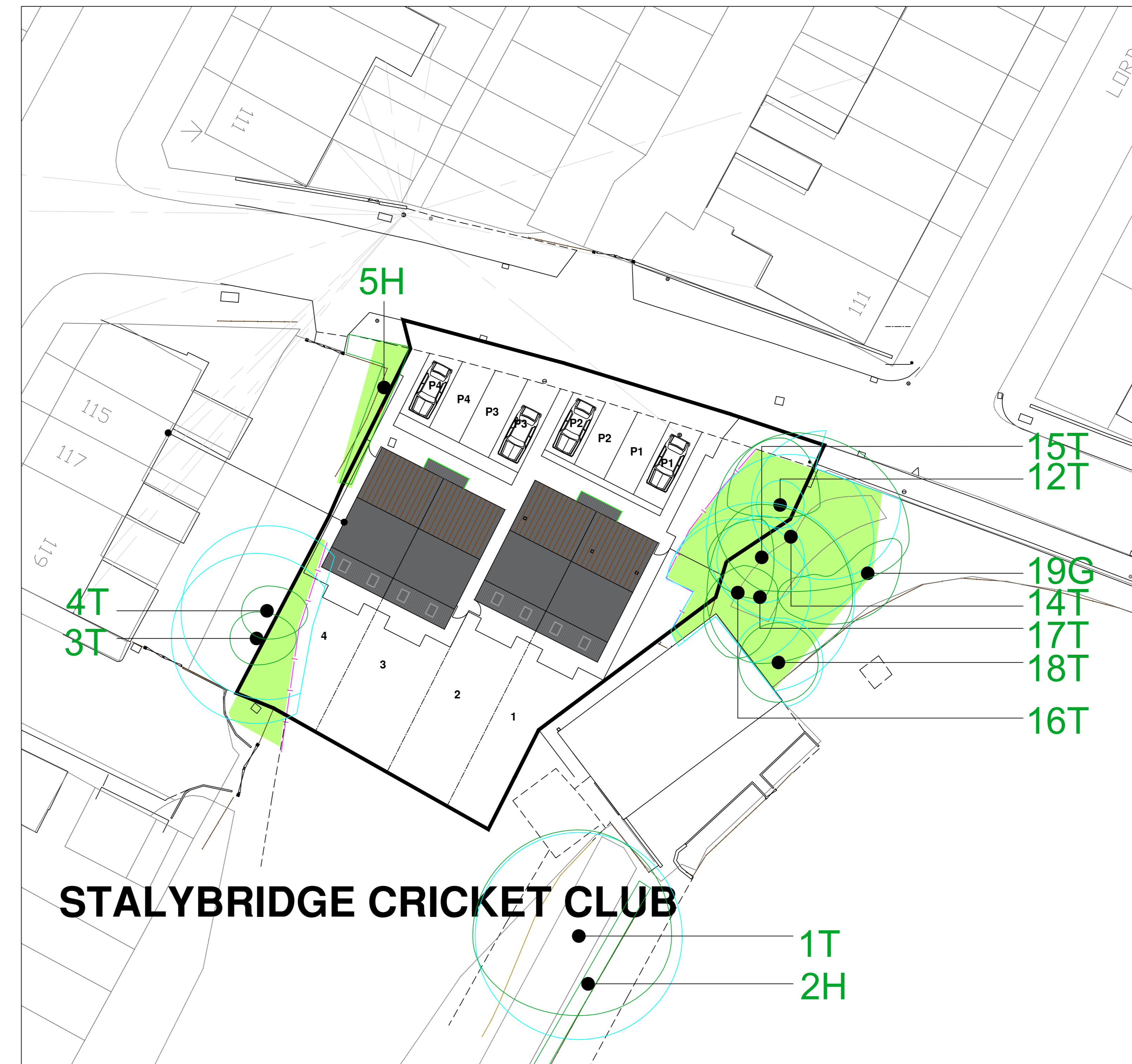

Phase	Requirements	Method														
1 Prior to erection of protective fencing.	Undertake tree and vegetation removal and pruning works. Trees/vegetation to be removed:	Refer to section 5.5 of AIA/MS report. All tree works to be carried out to BS3998: 2010: by suitably qualified and insured professional tree surgeons. The following tree felling must be undertaken at this Phase: Items requiring removal: <table border="1"> <tr><td>6T</td><td>Flowering Cherry</td></tr> <tr><td>7T</td><td>Sycamore</td></tr> <tr><td>8T</td><td>Sycamore</td></tr> <tr><td>9T</td><td>Sycamore</td></tr> <tr><td>10T</td><td>Wild Cherry</td></tr> <tr><td>11T</td><td>Sycamore</td></tr> <tr><td>13T</td><td>Standing Dead Tree</td></tr> </table>	6T	Flowering Cherry	7T	Sycamore	8T	Sycamore	9T	Sycamore	10T	Wild Cherry	11T	Sycamore	13T	Standing Dead Tree
6T	Flowering Cherry															
7T	Sycamore															
8T	Sycamore															
9T	Sycamore															
10T	Wild Cherry															
11T	Sycamore															
13T	Standing Dead Tree															
2 Prior to any construction works on site	Erection of protective fencing: To retain throughout the duration of the development:	Protective fencing is to be erected in accordance with 5.6 of AIA/MS report. The fencing must comply with the positions shown in the Tree Protection Plan. A scale copy of the Tree Protection Plan must be used as reference and fencing positions measured from the Plan using a scale rule and/or using the provided distances where shown. No works, no storage of materials, no access, or any ground disturbance is to take place within the Tree Protection Barrier Fencing other than works specified within the Arboricultural Method Statement. Fenced areas are to be treated as Construction Exclusion Zones. Warning signs to be placed on all protective fencing. For large sections of fencing the signs must be placed at 20m intervals. Signs must be laminated and securely attached at all corners. Two signs are to be placed side by side, copies of which are attached within Appendix A .														
3 Verifying quality of protective barriers	Verify that the location and quality of tree protection barriers is adequate prior to onset of main site works.	Site visit with Arboricultural Consultant and Site Manager. Tree Officer to be pre-informed of visit. In order for set works to proceed the pro-forma in Appendix B . of the AIA/MS report is to be completed and passed on to the local planning authority. If the protective barriers are not adequately, work is not to proceed until rectified.														
4 Ongoing	Maintain protective fencing	The tree protective barrier fencing is to remain in situ during all construction works.														

Phase	Requirements	Method
5 Removal of hard surface areas	Controlled removal of existing road surfaces situated adjacent trees to be retained.	A single panel of the tree protective fencing is to be removed to allow controlled access. 1. Present during the work must be the project arboriculturalist/site manager and site operatives. 2. A panel from the tree protection fencing is to be removed in order to access the works area. 3. Prybars and/or jackhammer to be used to break edges of surface nearest the trees. 4. A mechanical digger to be used to 'peel' away surface of existing road. 5. Mechanical plant is to operate from the intact surfaces of the road, working back. A layer of no-more than 200mm depth good quality top soil to be placed over the removed hard surface to allow for subsequent laying of turf.
6 Completion of main construction and undertaking of landscaping	Landscaping and dismantling of tree barrier protective fencing.	It is essential that ground levels within the root protection areas are not altered, either by raising or lowering soil levels, even at the landscaping stage. Landscaping within the root protection area of trees must be undertaken in the following manner: 1. Any existing ground flora (grass/weeds/scrub) is to be sprayed with a systemic herbicide and left to die-off. 2. Dead flora is to be strimmed as hard as possible with a brush cutter or similar. The bulk of the strimmed material is to be removed by raking. 3. A good quality organic topsoil layer may be placed down. Small depressions may be filled (and lightly compacted underfoot). Placed topsoil soil layers must not exceed 100mm depth. 4. No plant machinery operating within the root protection areas to exceed 1 tonne gross weight and must only operate from proprietary ground protection boards such as DuraMatt Access Mats (see Appendix C). 5. Turf and other planting to proceed thereafter.
7 Completion of main construction and installation of boundary treatments	Garden and perimeter fencing within RPA of retained trees	Within the RPAs of retained trees the wooden fencing shall be installed as follows: 1. Hand tools only 2. Exploratory post holes to be dug. Any roots encountered less than 2.5cm diameter should be cleanly cut back. 3. Roots in excess of 2.5cm can only be removed once arboricultural advice has been sought. 4. Where roots in excess of 8cm are encountered, an alternative location for the post hole is required. 5. Prior to the pouring of concrete a non-permeable membrane must fully line the post hole.

Tree Schedule			
Tree Number	Species	RPA Radius	Category
1T	Aspen	7.8m	B2
2H	Hawthorn Hedge		C1
3T	Leyland Cypress		C1
4T	Leyland Cypress		C1
5H	Privet Hedge		C1
6T	Flowering Cherry		C3
7T	Sycamore		B2
8T	Sycamore	3.3m	C1
9T	Sycamore		B2
10T	Wild Cherry	3.9m	C2
11T	Sycamore	2.4m	C1
12T	Sycamore	1.8m	C3
13T	Standing Dead Tree		U
14T	Sycamore		C1
15T	Sycamore	3.3m	C1
16T	Sycamore		C1
17T	Aspen		C1
18T	Silver Birch		C1
19G	3x Privet		C3

THIS DRAWING MUST BE VIEWED IN COLOUR AND READ IN CONJUNCTION WITH ARBORICULTURAL IMPACT ASSESSMENT AND METHOD STATEMENT

BS 5837 (2012) Tree Protection Fencing NOTES

1. STANDARD SCAFFOLD POLES. 2. HEAVY GAUGE 2 M TALL GALVANIZED TUBE AND WELDED MESH INFILL PANELS. 3. PANELS SECURED TO UPRIGHTS AND CROSS-MEMBERS WITH WIRE TIES. 4. GROUND LEVEL. 5. UPRIGHTS DRIVEN INTO THE GROUND UNTIL SECURE (MINIMUM DEPTH 0.6 M). 6. STANDARD SCAFFOLD CLAMPS.

Tree Protection Plan

Date: DEC 21 1:200 @ AO
Dwn: MG
Scale(s): 1:200 @ AO
Dwg no: 6638 02
Rev:

Project: Stalybridge St. Pauls Cricket Club
Gorse Hall Road, Duckinfield
McCorry Brickwork Ltd

TBA
Landscape Architecture
Trevor Bridge Associates Ltd
Ashboro Old Barrie
Stamford Street West
Aston-on-Lyne
Lancs OL6 7FW
Tel: 0161-804 2099
E-mail: info@trevorbridge.co.uk